

Instructions¹ vaginal swab specimen - clinician instructed self-collection

Do not pre-wet swab in cobas® PCR Media or any other liquid before collection

Preparing for sample collection:

- Undress to expose the vaginal area.
- Put yourself in a comfortable position.
- Remove the collection tube and swab from the collection kit.

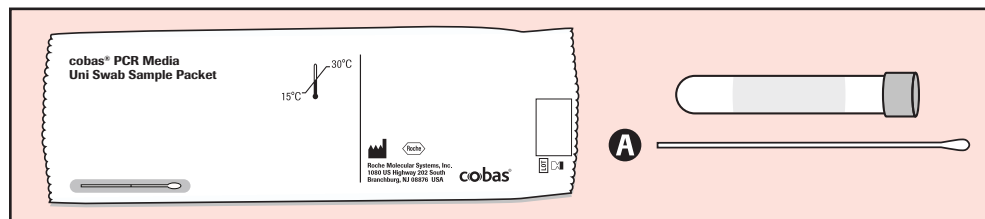

The **cobas®** PCR Media Uni Swab Sample kit contains:
cobas® PCR Media Tube
Woven Swab: A

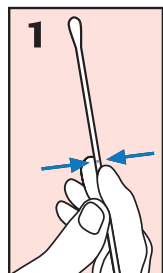

1. POSITION:
In one hand, hold the swab with the scoreline above your hand and with the other hand separate the folds of skin around the vaginal opening (labia).

4. ALIGN:
Lower the swab into the tube until the visible scoreline on the shaft is lined up with the tube rim.

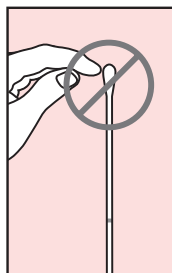
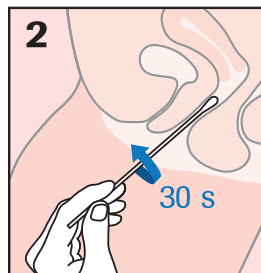
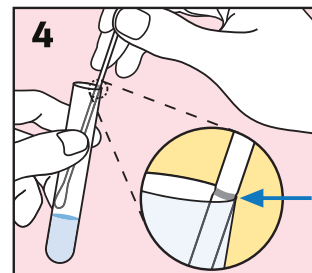

2. COLLECT:
Insert the swab about 5 cm (2 inches) into the vaginal opening. Gently turn the swab for about **30 seconds** while rubbing the swab against the wall of the vagina. Remove the swab carefully. **Do not touch the swab to any surface** before placing it into the collection tube.

HANDLING PRECAUTIONS:
The collection tube media can cause irritation if contacted with skin or other body parts.

In case the contents of the tube are accidentally spilled, do not attempt to clean up. Immediately notify your healthcare provider for appropriate action.

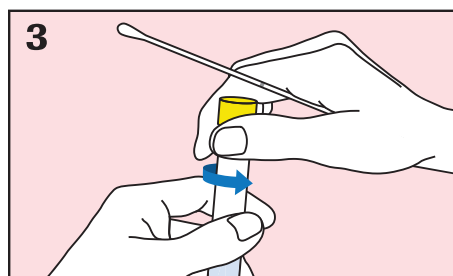

3. OPEN TUBE:
While holding the swab in the same hand, remove the cap from the tube as shown in the diagram.

5. BREAK:
Carefully lean the swab against the tube rim to **break the swab shaft at the scoreline**.



6. CLOSE:
Tightly close the **cobas®** PCR Media tube. Return the sample to your healthcare provider as instructed. **Discard the top portion of the swab.**

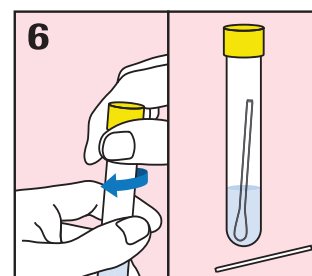

Transport: 2°C to 30°C ▪ **Stability of sample:** 12 months

THE SPECIMEN WILL BE REJECTED IF THERE IS:

- Presence of two swabs within the same tube
- No swab within the tube
- Excess of blood (>5%)



¹ Individuals collecting or directing the collection of samples should consult the complete instructions for use.